

## RIVET HEAD



Patent pending



- Simply convert the standard cordless, electric, pneumatic drill/driver into a blind rivet gun.
- Accept 3/8" & 1/2" (10/13mm) drill chuck or 1/4" (6.35mm) hex recess.
- Compatible with 12V, 14.4V and 18V cordless drill/driver and any reversible corded drill/driver.
- Pulls aluminum rivets 2.4mm - 4.8mm, stainless steel rivets 2.4mm - 4.0mm.
- Comes complete 2.4, 3.2, 4.0, 4.8mm (3/32", 1/8", 5/32", 3/16") 4 nosepieces.
- The shank of rivet is expelled when the drill is operated in the "reverse" mode.

Note: If used with a combine impact drill, ensure that it is set to drilling mode.

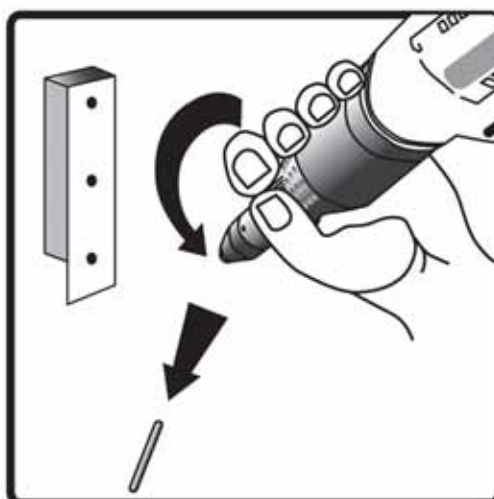
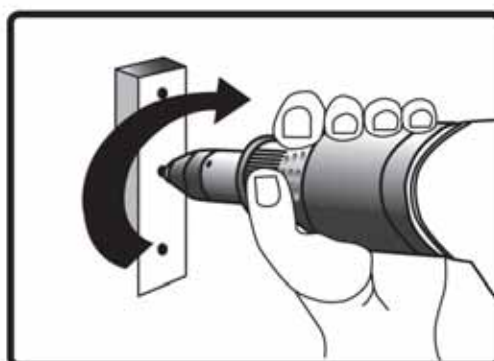
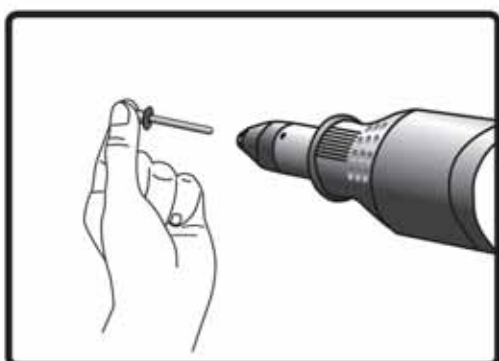
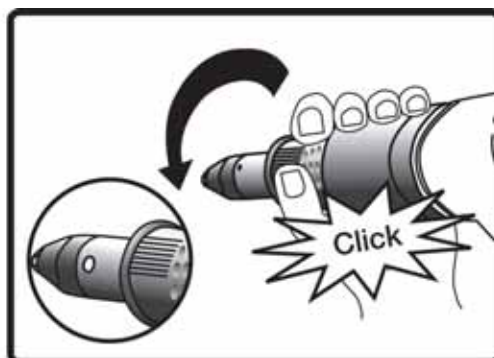
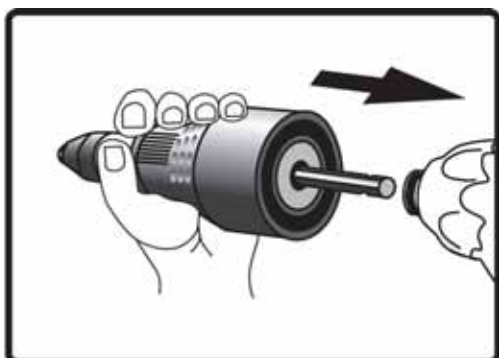

**拉釘 BLIND RIVETS SYSTEM**

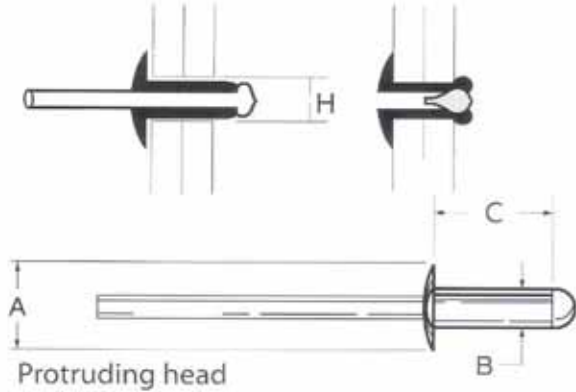

ITEM SIZE					TS. AAS.	TS. SAS.	TS. SSAS.	TS. SSASS.
A (HEAD DIA)	B (BODY DIA)	(INCH)	C (LENGT)	(INCH)	ALUMINUM RIVET STEEL SHAFT	STEEL RIVET STEEL SHAFT	STAINLESS STEEL RIVET STEEL SHAFT	STAINLESS STEEL RIVET STAINLESS STEEL SHAFT
3-2	4.5mm	2.4mm	(3/32)	5.8mm (.23)	TS. AAS 3-2	TS. SAS 3-2		
3-3	4.5mm	2.4mm	(3/32)	7.4mm (.30)	TS. AAS 3-3	TS. SAS 3-3		
3-4	4.5mm	2.4mm	(3/32)	8.4mm (.33)	TS. AAS 3-4	TS. SAS 3-4		
4-1	6.4mm	3.2mm	(1/8)	4.8mm (.19)	TS. AAS 4-1	TS. SAS 4-1	TS. SSAS 4-2	TS. SSASS 4-2
4-2	6.4mm	3.2mm	(1/8)	6.4mm (.25)	TS. AAS 4-2	TS. SAS 4-2	TS. SSAS 4-3	TS. SSASS 4-3
4-3	6.4mm	3.2mm	(1/8)	8.0mm (.315)	TS. AAS 4-3	TS. SAS 4-3	TS. SSAS 4-4	TS. SSASS 4-4
4-4	6.4mm	3.2mm	(1/8)	9.6mm (.38)	TS. AAS 4-4	TS. SAS 4-4	TS. SSAS (11) 4-5	TS. SSASS (11) 4-5
4-5	6.4mm	3.2mm	(1/8)	11.5mm (.45)	TS. AAS 4-5	TS. SAS 4-5	TS. SSAS (12.3) 4-6	TS. SSASS (12.3) 4-6
4-6	6.4mm	3.2mm	(1/8)	12.7mm (.50)	TS. AAS 4-6	TS. SAS 4-6		
4-8	6.4mm	3.2mm	(1/8)	16.1mm (.63)	TS. AAS 4-8	TS. SAS 4-8		
5-1	8.0mm	4.0mm	(5/32)	5.8mm (.23)	TS. AAS 5-1	TS. SAS 5-1	TS. SSAS 5-2	TS. SSASS 5-2
5-2	8.0mm	4.0mm	(5/32)	7.0mm (.275)	TS. AAS 5-2	TS. SAS 5-2	TS. SSAS 5-3	TS. SSASS 5-3
5-3	8.0mm	4.0mm	(5/32)	8.5mm (.335)	TS. AAS 5-3	TS. SAS 5-3	TS. SSAS 5-4	TS. SSASS 5-4
5-4	8.0mm	4.0mm	(5/32)	10.0mm (.394)	TS. AAS 5-4	TS. SAS 5-4	TS. SSAS 5-5	TS. SSASS 5-5
5-5	8.0mm	4.0mm	(5/32)	11.4mm (.448)	TS. AAS 5-5	TS. SAS 5-5	TS. SSAS 5-6	TS. SSASS 5-6
5-6	8.0mm	4.0mm	(5/32)	13.0mm (.511)	TS. AAS 5-6	TS. SAS 5-6	TS. SSAS 5-8	TS. SSASS 5-8
5-8	8.0mm	4.0mm	(5/32)	16.5mm (.65)	TS. AAS 5-8	TS. SAS 5-8		
5-10	8.0mm	4.0mm	(5/32)	19.5mm (.77)	TS. AAS 5-10	TS. SAS 5-10		
6-1	9.0mm	4.8mm	(3/16)	6.4mm (.25)	TS. AAS 6-1	TS. SAS 6-1	TS. SSAS 6-2	TS. SSASS 6-2
6-2	9.0mm	4.8mm	(3/16)	7.4mm (.30)	TS. AAS 6-2	TS. SAS 6-2		
6-3	9.0mm	4.8mm	(3/16)	9.6mm (.38)	TS. AAS 6-3	TS. SAS 6-3	TS. SSAS (10.5) 6-4	TS. SSASS (10.5) 6-4
6-4	9.0mm	4.8mm	(3/16)	11.0mm (.44)	TS. AAS 6-4	TS. SAS 6-4		
6-5	9.0mm	4.8mm	(3/16)	12.7mm (.50)	TS. AAS 6-5	TS. SAS 6-5	TS. SSAS (13.5) 6-6	TS. SSASS (13.5) 6-6
6-6	9.0mm	4.8mm	(3/16)	14.5mm (.57)	TS. AAS 6-6	TS. SAS 6-6	TS. SSAS (16.5) 6-8	TS. SSASS (16.5) 6-8
6-8	9.0mm	4.8mm	(3/16)	17.5mm (.69)	TS. AAS 6-8	TS. SAS 6-8		
6-10	9.0mm	4.8mm	(3/16)	20.4mm (.80)	TS. AAS 6-10	TS. SAS 6-10		
6-12	9.0mm	4.8mm	(3/16)	24.0mm (.95)	TS. AAS 6-12	TS. SAS 6-12		

# Instruction Manual



## Übersicht | Overview

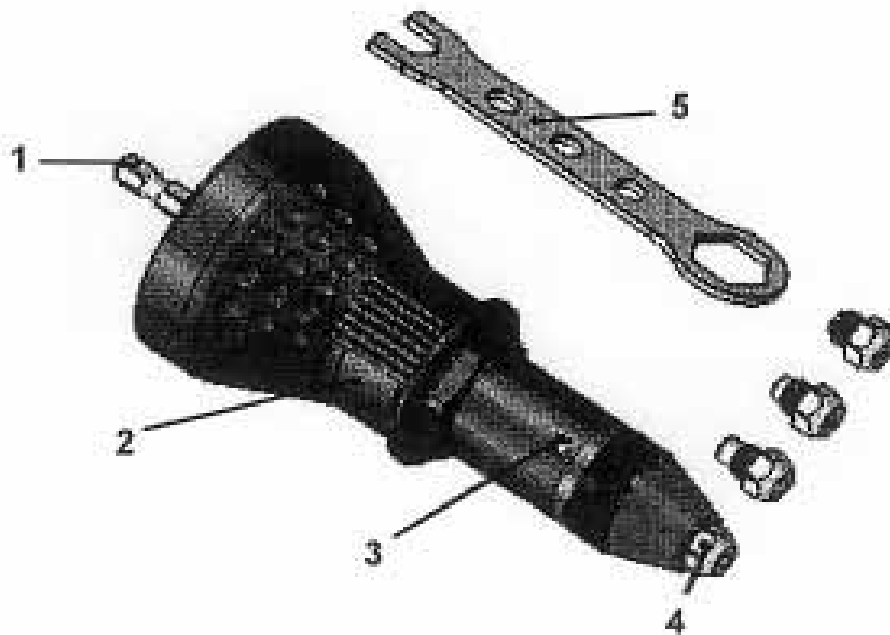

**Übersicht | Overview**

1	Sechskant Aufnahmestift	Hex Shank
2	Gehäuse	Housing
3	Sichtfenster	Sight Window
4	Mundstück	Nosepiece
5	Montageschlüssel	Wrench

Empfohlene Antriebs- maschinen		Recommended Drive Machine
Akku Bohrschrauber	12 V, 14,4 V, 18 V	Cordless Drill
Elektrische und pneumatische Bohrmaschinen mit Rechts-/Linkslauf		Reversible Electric and Pneumatic Drill/Driver
Minimaler Drehmoment	15 Nm	Minimum Torque



## Safety Notes

Please note the following safety notes to avoid malfunctions, damage or physical injury:

- Please observe all safety notes of the used driving tool (drill).
- Always switch off the driving tool and pull the power plug before maintaining the blind riveting attachment, e.g. changing the nose-pieces or when not in use.
- Only use the blind riveting attachment as indicated in this manual for setting blind rivets. The unit is not designed for continuous, professional use.
- Always secure the work piece.
- Do not wear loose clothing or jewellery. Tie up hair so hair or clothing cannot get into moving parts.
- Persons with limited physical, sensorial or mental abilities are not allowed to use the unit, unless they are supervised for their safety by a qualified person or are briefed by the responsible person how to use the unit.
- Only use the blind riveting attachment with the included nose-pieces.
- Should the unit become damaged do not use it and have it repaired by a professional or contact our customer support department. Do not disassemble the unit or try repairing it yourself.
- Do not continue using the unit if it was damaged or the unit was dropped down. Please contact our customer support service.



## Assembling and Using

### Before first Use

Remove the unit and the accessory out of the packaging. Keep packaging materials out of reach of children. There is risk of suffocation!

### Assembling and Using

1. Secure the work piece. Drill the holes into the work piece. The diameter of the holes has to match the diameter of the blind rivets.
2. Attach the blind riveting attachment as a bit into the drill chuck of the driving tool.
3. Hold the blind riveting attachment firmly in your hand and start the driving tool with left-hand rotation. Allow the tool to run slowly until you hear a click sound. Now the collet inside the blind riveting attachment is opened and ready for inserting a blind rivet.
4. Select the correct nosepiece for the needed blind rivets and screw the nosepiece on the blind riveting attachment by using the included wrench. Insert a blind rivet into the nosepiece.
5. Select right-hand rotation and make sure the speed of the driving tool is not too high.

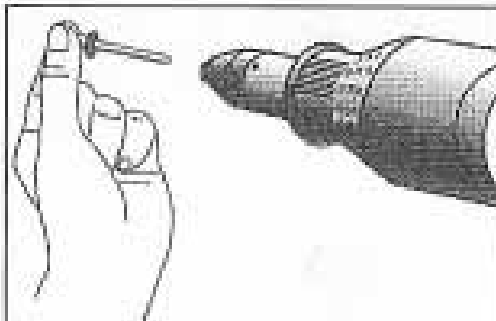
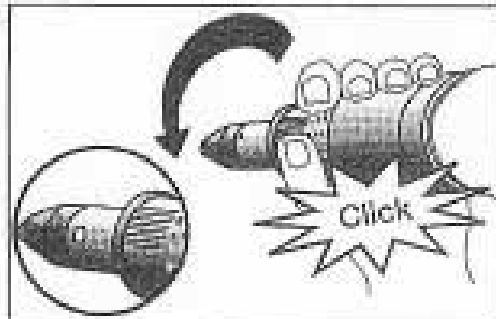
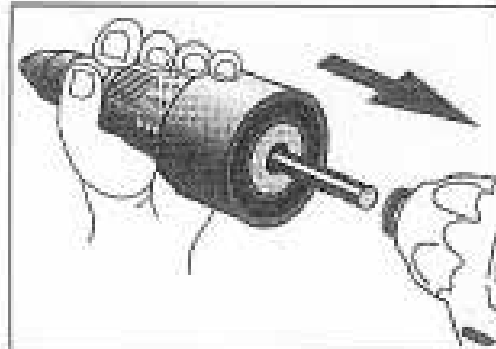





## Assembling and Using

6. Firmly press the blind riveting attachment on the work piece and start the driving tool with right-hand rotation. Firmly hold the driving tool and the blind riveting attachment with both hands.

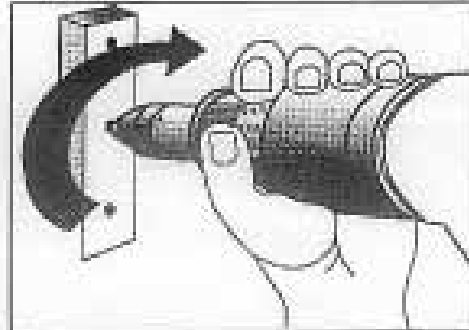

The blind rivet is grasped by the jaws and pulled inwards. As soon as the rivet is pulled completely inwards, the blind rivet attachment cuts the rivet flush with the nose-piece.

7. Now set the driving tool to left-hand rotation. Start the machine until the spent rivet mandrel is expelled from the blind riveting attachment.

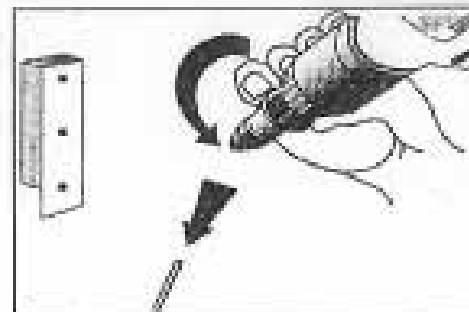

## Troubleshooting

1. If a rivet mandrel is jammed in the jaws, completely unscrew the top black part of the blind riveting attachment by turning counter clockwise and remove.
2. Turn the hex shank of the attachment by hand and turn counter clockwise until the collet of the jaws slide upwards. If a rivet mandrel is jammed by the jaws, carefully tap out or remove the jammed piece by using pliers or similar tools.

## Cleaning and Storing

- Before cleaning or maintaining, first disconnect the plug from power mains and make sure the driving tool cannot get started inadvertently.
- Do not wipe the blind riveting attachment with sharp detergents or aggressive chemicals in order not to damage the surfaces.



**Technische Daten | Technical Data**

Typ		Type
Abmessungen	Ø 59 mm x 165 mm	Dimensions
Gewicht	300 g	Weight
Mundstücke	2,4 – 3,2 – 4,0 – 4,8 mm	Nosepieces
Arbeitsbereich		Capacity
Aluminiumnieten	2,4 mm – 4,8 mm	Aluminium Rivets
Edelstahlnieten	2,4 mm – 4,0 mm	Stainless Steel Rivets
Aufnahme	6,35 mm	Hex Shank
Empfohlene Antriebsmaschinen		Recommended Drive Machines
Akku Bohrschrauber	12 V, 14,4 V, 18 V	Cordless Drill
Elektrische und pneumatische Bohrmaschinen mit Rechts-/Linkslauf		Reversible electric and pneumatic Drill/Driver
Min. Drehmoment	15 Nm	Min. Torque Strength



## Dear Customers

Please familiarize yourself with the proper usage of the unit by reading and following each chapter of this manual, in the order presented. Keep these operating instructions for further reference.

This operating instruction contains important details for handling the unit. Please pass it on along with the unit if it is handed over to a third party!

Please read all safety instructions!

These instructions will make it easier for you to handle the unit and help prevent misunderstandings and possible damage or injury.